

仅供参考

REV.	REVISION RECORD	DATE
A0	新图面发行	2017.06.16

**主要技术参数 Main Specifications**

线数 (Poles): 02 to 24  
 接触电阻 (Contact resistance):  $\leq 20m\Omega$   
 绝缘电阻 (Insulation resistance):  $\geq 1000M\Omega$   
 额定电压 (Rated voltage): 250V AC DC  
 额定电流 (Rated current): 5.0A AC DC  
 耐电压 (Withstand Voltage): 1000V AC/minute  
 温度范围 (Temperature Range):  $-25^{\circ}C \sim +85^{\circ}C$

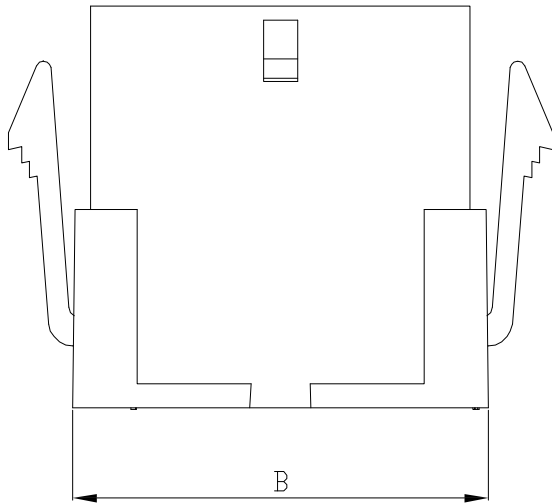
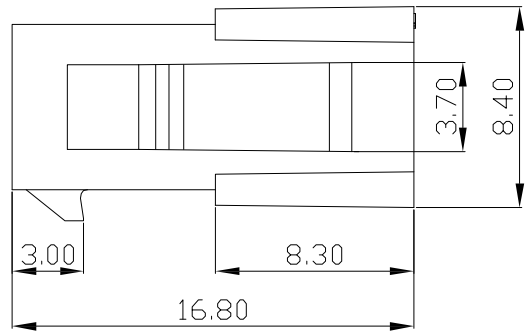
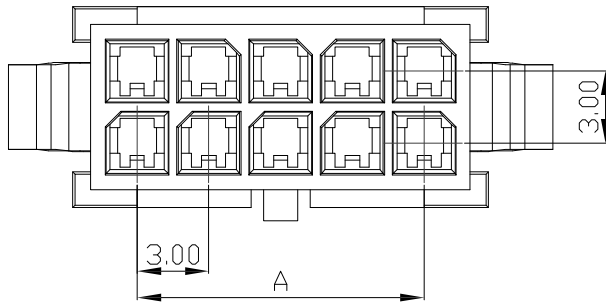
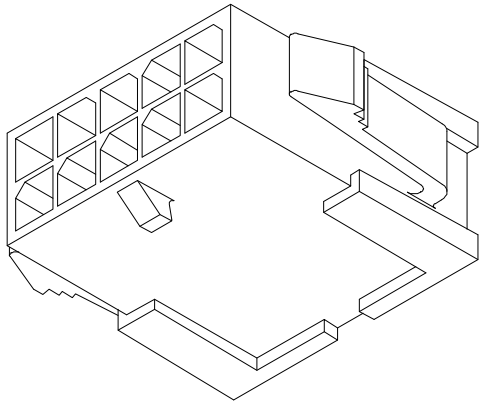

Poles	Dimensions mm	
	A	B
2	—	5.35
4	3.00	8.35
6	6.00	11.35
8	9.00	14.35
10	12.00	17.35
12	15.00	20.35
14	18.00	23.35
16	21.00	26.35
18	24.00	29.35
20	27.00	32.35
22	30.00	35.35
24	33.00	38.35

1	Housing	PA66	1	Black	
序号	图号	名称	材料	数量	附注

	GENERAL TOLERANCES		SCALE: 1:1	NAME	DATE	深圳市思拓展电子有限公司 SHENZHEN SINOTOP ELECTRONICS CO., LTD 公司网址: www.szstuo.cn 公司电话: 0755-23765350 邮 箱: 2850175982@qq.com 公司传真: 0755-23765341	PART. NO: ST-WF-300-002A	
	LINEAR	ANGLES	APPROVED				DWG. NO:	
	0.0±0.30	X° REF±6°	DESIGNER					
	UNIT: MM	0.00±0.20	X° ±3°	DRAWN	肖坤权		2017.06.16	TITLE: 3.00mmPITCH HOUSING
SIZE: A4	0.000±0.10	X° X'±2°						

仅供参考

REV.	REVISION RECORD	DATE
A0	新图面发行	2017.06.16

**主要技术参数 Main Specifications**

线 数 (Poles): 02 to 24  
 接触电阻 (Contact resistance):  $\leq 20m\Omega$   
 绝缘电阻 (Insulation resistance):  $\geq 1000M\Omega$   
 额定电压 (Rated voltage): 250V AC DC  
 额定电流 (Rated current): 5.0A AC DC  
 耐 电压 (Withstand Voltage): 1000V AC/minute  
 温度范围 (Temperature Range) :  $-25^{\circ}C \sim +85^{\circ}C$

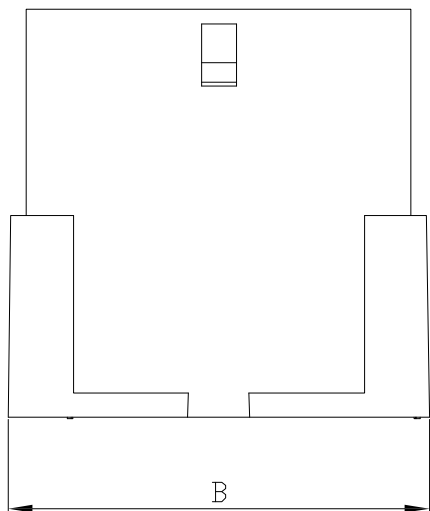
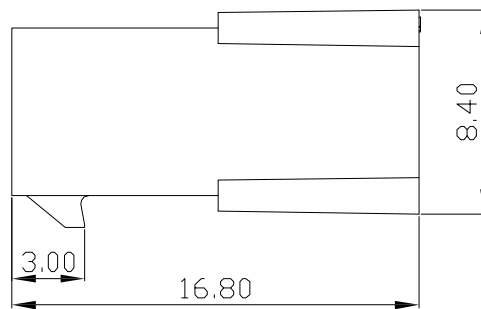
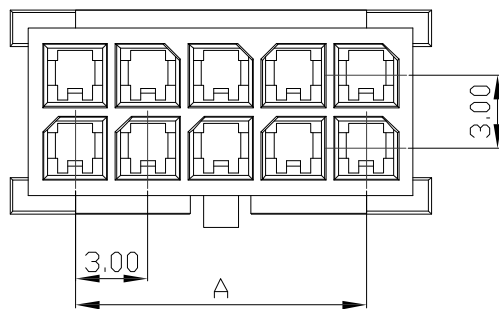
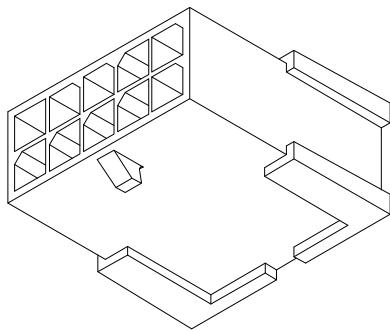

Poles	Dimensions mm	
	A	B
2	—	5.35
4	3.00	8.35
6	6.00	11.35
8	9.00	14.35
10	12.00	17.35
12	15.00	20.35
14	18.00	23.35
16	21.00	26.35
18	24.00	29.35
20	27.00	32.35
22	30.00	35.35
24	33.00	38.35

1	Housing	PA66	1	Black	
序号	图号	名称	材料	数量	附注

	GENERAL TOLERANCES		SCALE: 1:1	NAME	DATE	深圳市思拓展电子有限公司 SHENZHEN SINOTOP ELECTRONICS CO., LTD 公司网址: www.szstuo.cn 公司电话: 0755-23765350 邮 箱: 2850175982@qq.com 公司传真: 0755-23765341	PART. NO: ST-WF-300-002AF	
	LINEAR	ANGLES	APPROVED				DWG. NO:	
	0.0±0.30	X° REF±6°	DESIGNER				TITLE: 3.00mmPITCH HOUSING	REV: A0
	UNIT: MM	0.00±0.20	X° ±3°	DRAWN	肖坤权		2017.06.16	SHEET: 1/1
SIZE: A4	0.000±0.10	X° X'±2°						

仅供参考

REV.	REVISION RECORD	DATE
A0	新图面发行	2017.06.16

主要技术参数 Main Specifications

- 接触电阻 (Contact resistance):  $\leq 20m\Omega$
- 绝缘电阻 (Insulation resistance):  $\geq 1000M\Omega$
- 额定电压 (Rated voltage): 250V AC DC
- 额定电流 (Rated current): 5.0A AC DC
- 耐电压 (Withstand Voltage): 1000V AC/minute
- 温度范围 (Temperature Range):  $-25^{\circ}C \sim +85^{\circ}C$

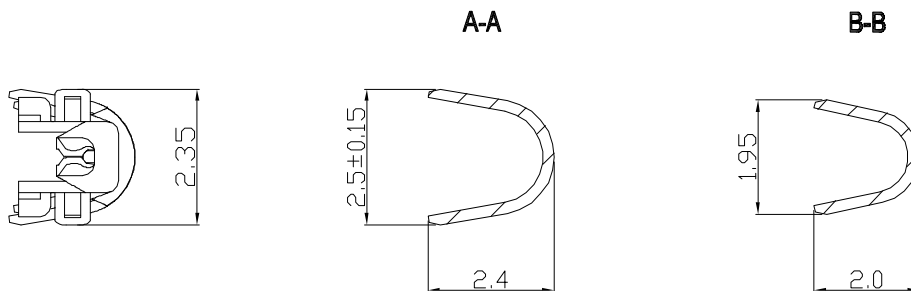
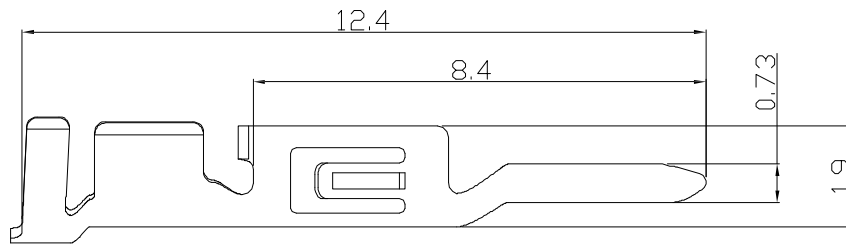
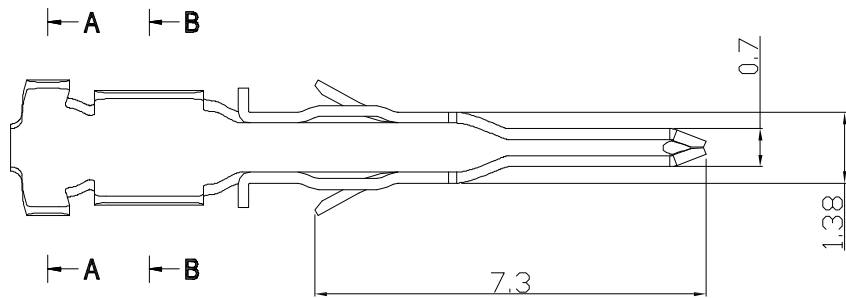
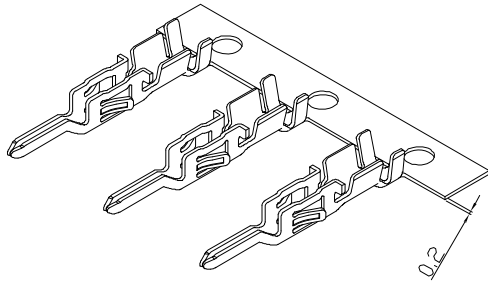

Wire Range	Insulation O. D.	Material	Finish	Qty/Reel
AWG #20~#30		Phosphor bronze	Tin-plated	

	GENERAL TOLERANCES		SCALE: 1:1	NAME	DATE	深圳市思拓展电子有限公司 SHENZHEN SINOTOP ELECTRONICS CO., LTD 公司网址: www.szsituo.cn 公司电话: 0755-23765350 邮 箱: 2850175982@qq.com 公司传真: 0755-23765341	PART. NO: ST-WF-300-001AT	
	LINEAR	ANGLES	APPROVED				DWG. NO:	
UNIT: MM	0.0±0.30	X° REF±6°	DESIGNER			TITLE:	REV: A0	SHEET: 1/1
SIZE: A4	0.000±0.10	X° X'±2°	DRAWN	肖坤权	2017.06.16	3.00mm PITCH TERMINAL		